



PETAL PARK

Designed By:

**Asa Couture, Kenny Nguyen,
Diana Druhora, Lilit Ayrapetyan**

**DX Toronto Competition
Connect: Free Play**

Petal Park is a structure designed to bring people together in celebration of Canada's environment, specifically, its greenery. Our team envisioned the structure being built in an area that is unused and inaccessible, Toronto's harbor front. Petal Park would be constructed over the water and connected to a dock, allowing people to get fully away from Toronto's busy city life and escape into what some of Canada's flora has to offer.

The design incorporates sustainable and environmentally friendly materials in its construction. We wanted Petal Park to be as green friendly as possible to enhance the entire design. The walkway is entirely wheelchair accessible and invites all people to explore and experience Canada's best plants!

EXPLODED VIEW

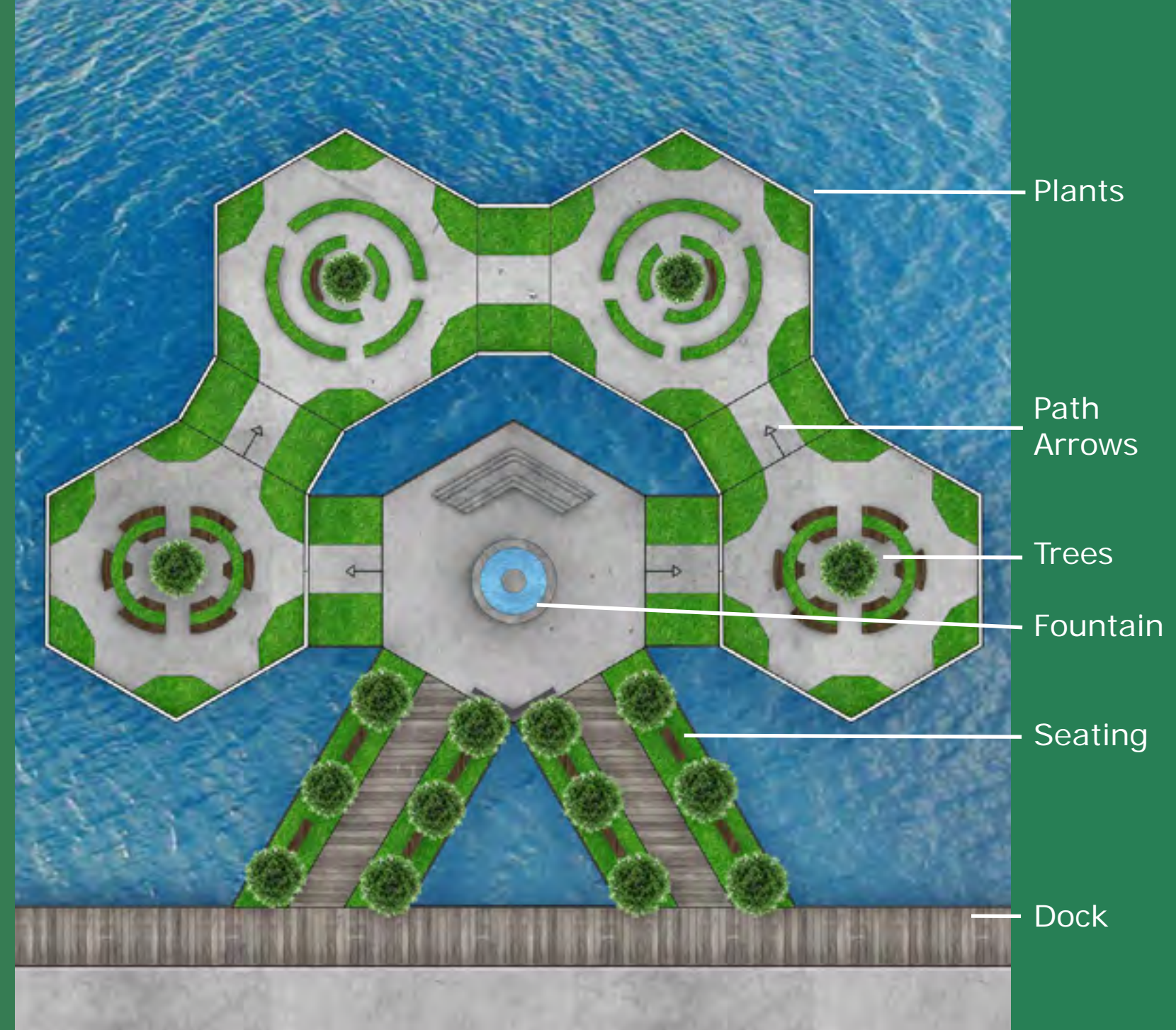
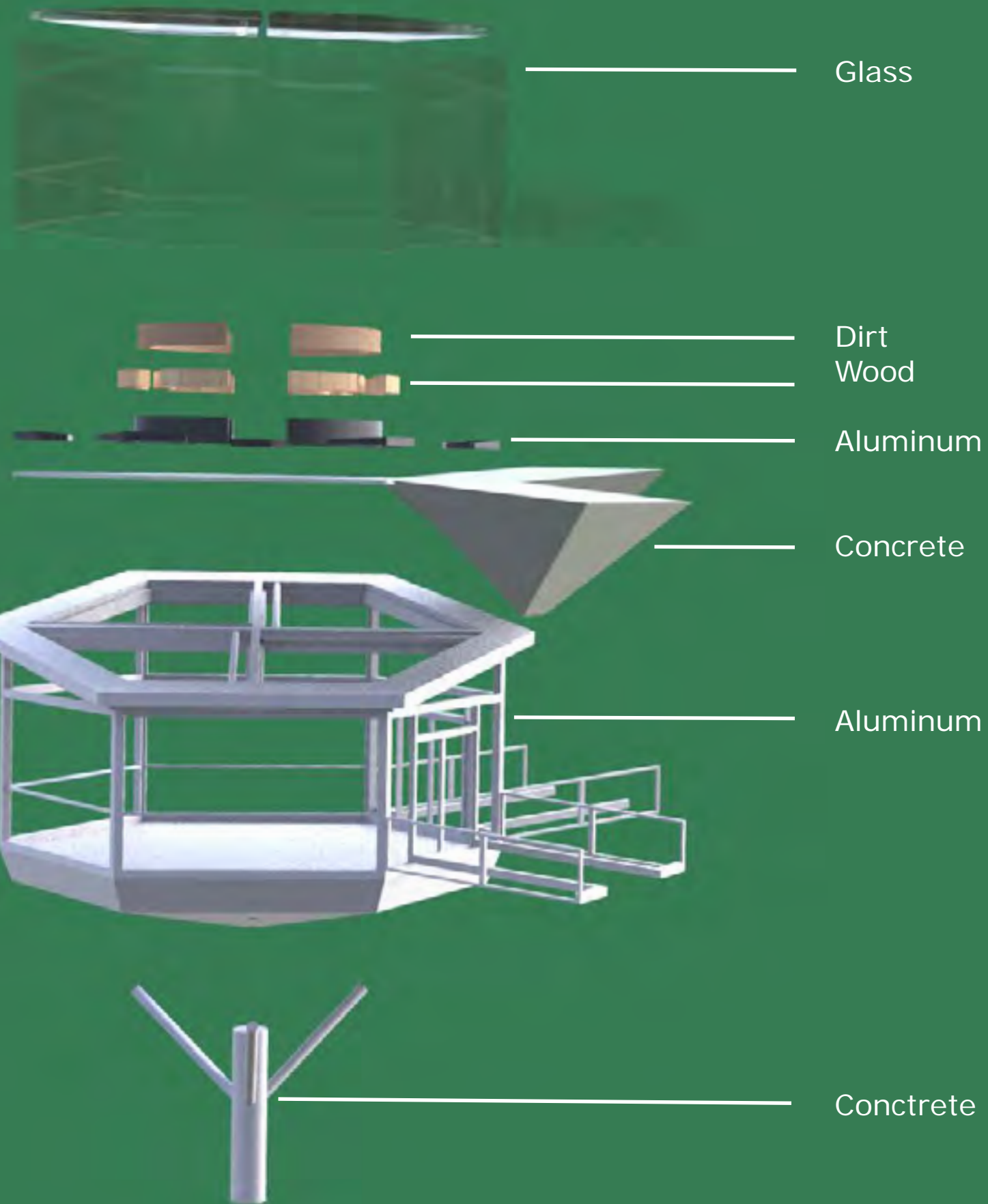

FLOOR PLAN

As a team we made sure the path through Petal Park would be easy and fun, as well as follow all regulations for safety and accessibility. The entire space is ergonomically easy for people to use, spaces are left open for wheelchairs, plants are at a height that not only adult but children and everyone else are easily able to see. There are displays layed out around the park for people to interact with and learn about some of Canadas greenery.



IN SITUATION

Here is Petal Park at Toronto's harbor front. The park would not only operate in warm seasons but also in cold by offering a festive element to the structure. In the end, Petal park is aimed at bring people from all walks of life together in celebration of canadian culture, its plants and the place so many of us call home.



THANK YOU